

CARE AND MAINTENANCE

⚠ WARNING

Drain livewell tank before you service the aerator. Failure to do so could result in a large volume of water flooding your boat.

If Aerator is installed thru-hull, BOAT MUST BE OUT OF THE WATER to remove or replace motor cartridge. The pump, plumbing and connections may be below the water level. Removing the cartridge while the boat is in the water may result in flooding and sinking of your boat.

1. Periodically check that the electrical connections are tight and waterproof.
2. All plumbing, clamps, and hoses must be secure and protected from wear and damage.

TO CLEAN OR REMOVE EXISTING MOTOR CARTRIDGE

1. Occasionally check pump to be certain debris is not restricting or jamming the impeller. Careful attention will provide peak performance.
2. To remove or replace cartridge: Hold pump housing firmly. Depress motor cartridge tabs, then remove it.

TO INSERT MOTOR CARTRIDGE

1. The cartridges are color-coded to help you match cartridge size to the aerator pump. Replace the existing motor cartridge **ONLY** with the seaflo motor cartridge. (Figure 5)
2. Coat O-ring with vegetable oil to ease insertion.
3. Insert cartridge into housing until you hear tabs snap up into slot.

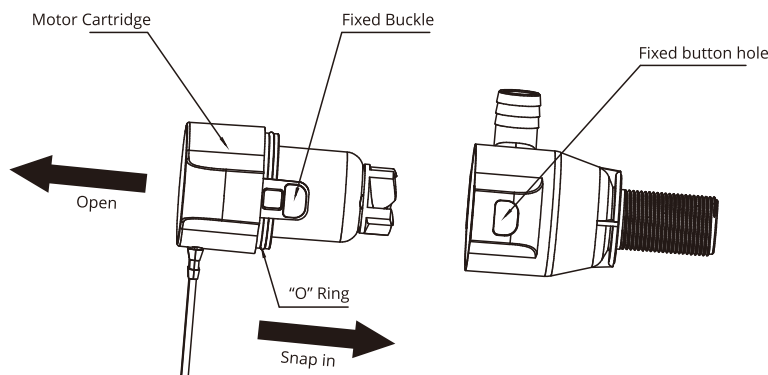

⚠ WARNING

To avoid leaking or sinking, the aerator RED TAB MUST BE LOCKED AND VISIBLE through aerator housing slot.

SEAFLO®

Protable Livewell Aerator Kit

Instruction Manual

FEATURES

The SEAFLO Livewell Aerator Kit is recommended for fishing boats with built-in livewells that are not equipped with a thru-hull recirculation system. The pump is sealed and can occasionally be submerged; however, the electrical wires must never be submerged.

STANDARD CONFIGURATIONS

Pump Model	Motor model	Flow rate	Volts	Current	Outlet Dia.
SFBP1-G600-13F	SFMA1-G600-13A	600 GPH	12V	3.0A	3/4"(19mm)
SFBP2-G600-13F	SFMA2-G600-13A	600 GPH	24V	1.5A	3/4"(19mm)
SFBP1-G800-13F	SFMA1-G800-13A	800 GPH	12V	4.0A	3/4"(19mm)
SFBP2-G800-13F	SFMA2-G800-13A	800 GPH	24V	2.0A	3/4"(19mm)

⚠ WARNING

Failure to heed the following warnings could cause your boat to sink or result in explosions, fires, and serious personal injury:

Do not use aerator kit to remove gasoline, oil or other flammable liquids.

Always disconnect the power source when installing or servicing any electrical product. Remove vessel from water when using any 110/120 volt AC power tools.

Use the correct fuse amperage rating specified for your model pump. Test circuit breaker protection as installed. Failure to do so could result in serious personal injury or fire hazard.

Do not use bilge pump hose, or any other type of unreinforced hose that could leak, split, or puncture.

REQUIRED FOR INSTALLATION

- In-line fuse holder with 5-ampere fuse
- Waterproof wire butt-connectors for #18 AWG wire
- Drill with 1-1/16" (27mm) or 1-1/8" (30mm) hole saw
- Phillips head screwdriver
- Brown and black lengths of #18 AWG insulated wire
- Polyurethane marine sealant for pump mounting threads
- Dash-mounted two-way switch
- Wrench for 1-1/4" and 1-1/2" nut
- 23" length of hose is provided; if longer length is needed, use 3/4" (19mm) inner diameter, smooth bore, reinforced hose

CHOOSE MOUNTING LOCATION FOR PUMP AND AERATOR HEAD

For Shallow Tanks

For tanks with less than 8" (20cm) water height between the aerator head and pump intake:

- Offset the mounting locations so the aerator head does not force air into the pump intake causing cavitation.
- For example, mount aerator head at the left side and the pump at right side of the tank. (Figure 1)

For Deeper Tanks

For tanks with more than 8" (20cm) water height between the aerator head and pump intake:

- Mount the aerator head and pump intake on the centerline of the livewell.
- This centerline location ensures the most even distribution of water flow. (Figure 2)

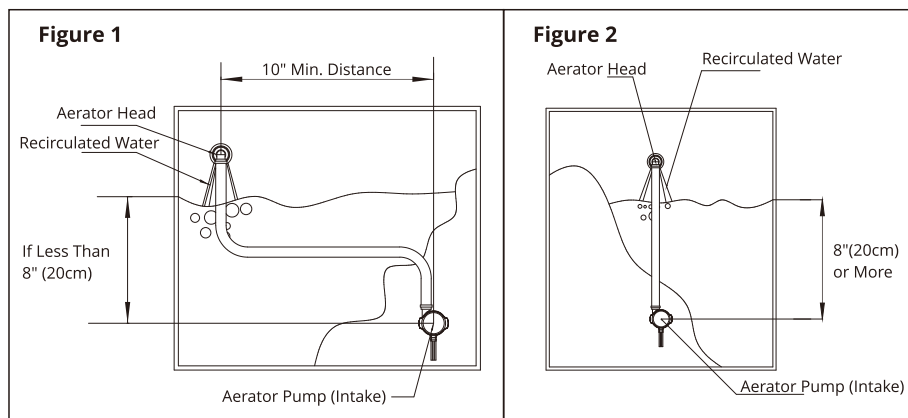

INSTALL AERATOR PUMP

1. Position aerator pump at least 2" (51mm) from bottom of tank. Maintain enough clearance for mounting flange and retaining nut. (Figure 3)
2. At chosen pump location, drill a hole of 1-1/16" (27mm) minimum diameter, but no larger than 1-1/8" (30mm) diameter, through tank.
3. Apply a bead of marine sealant around mounting flange. Insert pump through mounting hole in tank. Install and tighten retaining nut finger-tight, then an additional 1/2 to 3/4 turn.
4. Install and tighten stainless steel mesh strainer finger-tight.

INSTALL AERATOR SPRAY HEAD

1. Position aerator spray head 2" (51mm) down from top of tank. Maintain enough clearance for mounting flange and retaining nut. (Figure 3)
2. At chosen aerator location, drill a hole of 1-1/16" (27mm) minimum diameter, but no larger than 1-1/8" (30mm) diameter, through tank.
3. Apply a bead of marine sealant around mounting flange. Insert spray head through mounting hole in tank. Install and tighten retaining nut finger-tight, then an additional 1/2 to 3/4 turn with wrench.

INSTALL AERATOR SPRAY HEAD

1. Position aerator spray head 2" (51mm) down from top of tank. Maintain enough clearance for mounting flange and retaining nut. (Figure 3)
2. At chosen aerator location, drill a hole of 1-1/16" (27mm) minimum diameter, but no larger than 1-1/8" (30mm) diameter, through tank.
3. Apply a bead of marine sealant around mounting flange. Insert spray head through mounting hole in tank. Install and tighten retaining nut finger-tight, then an additional 1/2 to 3/4 turn with wrench.

INSTALL HOSE

1. Install hose barbed fitting on pump outlet. Tighten by hand, then an additional 1/4 to 1/2 turn with wrench. (Figure 3)
2. Cut connecting hose (provided) to proper length. If longer hose is needed, use 3/4" (19mm) inner diameter, smooth bore, reinforced hose.
3. Attach one end of hose on pump outlet, other end on spray head inlet. Secure with provided hose clamps.
4. Check fittings and system for leaks.

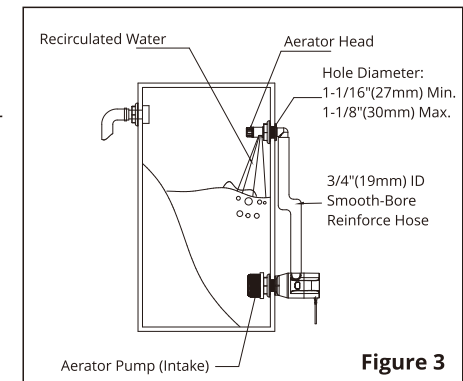

WIRING INSTRUCTIONS

Make all wire connections above any bilge water accumulation, using marine-grade waterproof wire connectors only.

NOTE: Failure to make waterproof connections and fuse pump properly will void the product warranty.

1. Using insulated terminal connectors, connect positive lead (brown) to ON/OFF switch. Connect negative lead (black) to ground. (Figure 4)
2. In a location easily accessible for changing fuses, splice fuse holder with 3-amp fuse into positive lead (brown). Fuse holder must be installed not more than 72" (1.83m) from positive (+) battery terminal.
3. To check system, feed water into the pump. If flow seems too low, make sure wires have been properly connected – brown to positive (switch), black to negative.

